

FORM No. 1.

Courses down the River

- 1. S. 16. W. 30
- 2. S. 25. W. 32
- 3. S. 16. W. 20
- 4. S. 6. W. 8

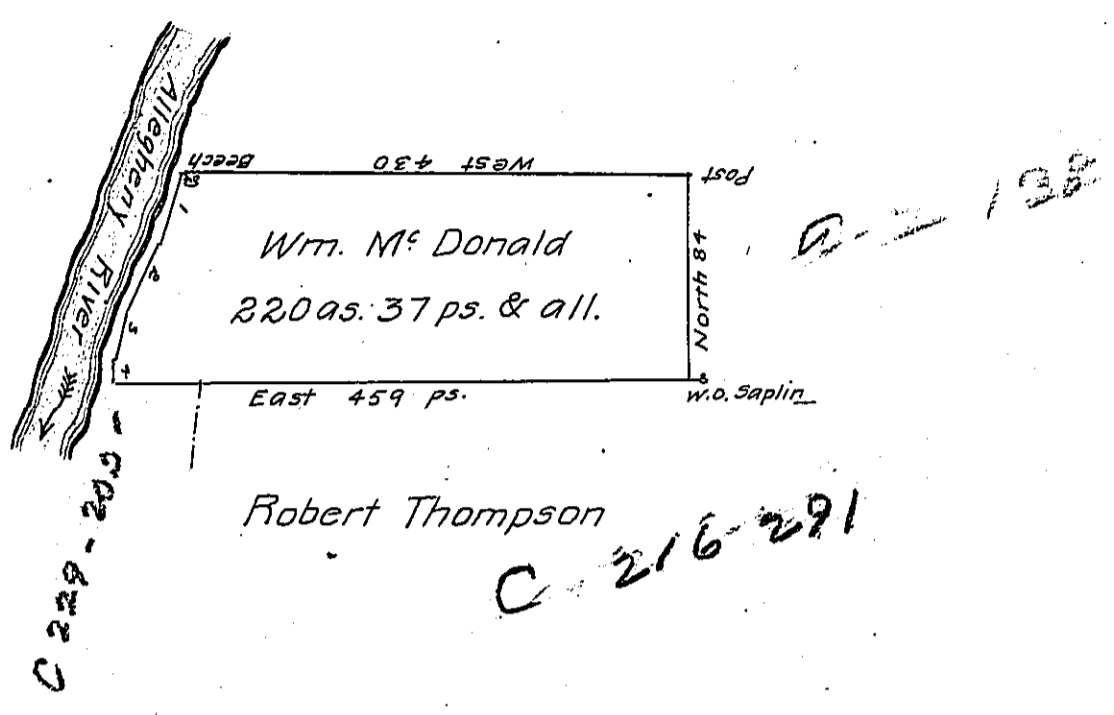

Draft of a tract of Land Situate in late Limestone now

Pleasant township Warren County East of the Allegheny River adjoining
 Said River on the West on the South Land Survey'd Robert Thompson East
 Lancaster Land Co. on the North Land Surveyed on Warrent granted John
 Thompson Surveyed on Warrent Granted William M^cDonald dated 29th
 Day of May 1835 Containing two hundred twenty — acres thirty seven
 pers. & allowan.

John Andrews D.S.

Jacob Spangler Esq. }
 Surveyor General }

Warren County

IN TESTIMONY that the above is a copy of the original remaining on file in
 the Department of Internal Affairs of Pennsylvania, made
 conformably to an Act of Assembly approved the 16th day of
 February, 1833, I have hereunto set my Hand and caused
 the Seal of said Department to be affixed at Harrisburg,
 this fifth day of March 1906

Loac P Brown
 Secretary of Internal Affairs.